

Parting Tools F and G of HSS-CO (Kob), HSS (Rap), TiN-coated and with Carbide Tips

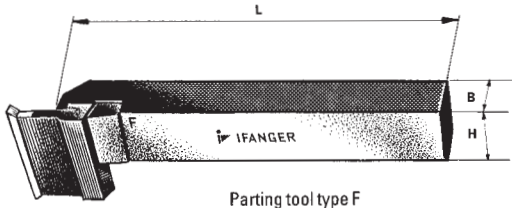

Parting tool type F

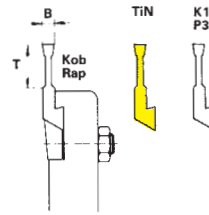

Type F (righthand)

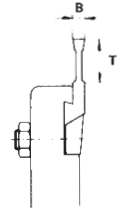

Type G (lefthand)

How to order (example): 10 pieces 2-F-N-TiN (Original box of 5 pieces)

Size	For height of centers above tool rest		Measurements H×B×L	Holder Code number	Availability	Length mm	B _{0.5} mm	T mm	Cutter Code number	Cutter Availability					T mm	extra depth Code number	Availability					
										normal	relieved	mm	Kob	Rap			TiN	K10	P30	Kob	Rap	TiN
Type F																						
1/12	12		12×10×110	1/12-FH	●	25	3	11	1-F-N...	●	●	●	●	●	16	1-F-T...	●	●	●			
1	16	15-12*	16×12×110	1-FH	●	25	3	11	1-F-N...	●	●	●	●	●	16	1-F-T...	●	●	●			
2	20	19-16*	20×15×140	2-FH	●	32	3.5	14	2-F-N...	●	●	●	●	●	19	2-F-T...	●	●	●			
3	25	24-20*	25×18×160	3-FH	●	41	4	17	3-F-N...	●	●	●	●	●	24	3-F-T...	●	●	●			
4	30	29-25*	30×21×180	4-FH	●	50	4.5	23.5	4-F-N...	●	●	●	●	●	33.5	4-F-T...	●	●	●			
5	36	35-30*	36×25×200	5-FH	●	60	5.5	30	5-F-N...	●	●	○	●	●	40	5-F-T...	●	●	○			
Type G																						
1/12	12		12×10×110	1/12-GH	●	25	3	11	1-G-N...	●	●	●	●	●	16	1-G-T...	●	●	●			
1	16	15-12*	16×12×110	1-GH	●	25	3	11	1-G-N...	●	●	●	●	●	16	1-G-T...	●	●	●			
2	20	19-16*	20×15×140	2-GH	●	32	3.5	14	2-G-N...	●	●	●	●	●	19	2-G-T...	●	●	●			
3	25	24-20*	25×18×160	3-GH	●	41	4	17	3-G-N...	●	●	●	●	●	24	3-G-T...	●	●	●			
4	30	29-25*	30×21×180	4-GH	●	50	4.5	23.5	4-G-N...	●	●	●	●	●	33.5	4-G-T...	●	●	●			
5	36	35-30*	36×25×200	5-GH	●	60	5.5	30	5-G-N...	●	●	○	●	●	40	5-G-T...	●	●	○			

▲ Please indicate here the alloy or grade of carbide required ▲

* When requiring intermediate measures, please indicate height of center or of shank (quick change tool posts), e.g. 4-FH-h.-center 28 or 4-FH-h.-shank 28.

Parting Tool Holder GHS

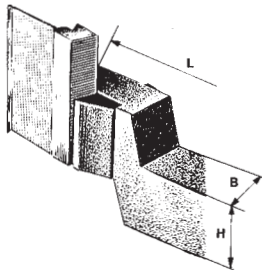

This toolholder is specifically designed for use on old machines which lack rigidity. The cutting edge of the blade faces downwards and parts with workpiece rotating in the opposite direction to normal.

How to order (example): 1 piece 4-GHS

Size	For height of centers above tool rest		Measurements H×B×L	Holder GHS Code number	Availability	Length mm	B _{0.5} mm	T mm	Cutter Code number	Cutters for use on holder GHS Availability					T mm	Extra depth Code number	Availability					
										normal	relieved	mm	Kob	Rap			TiN	K10	P30	Kob	Rap	TiN
1	14	13-12*	16×12×120	1-GHS	●	25	3	11	1-G-N...	●	●	●	●	●	16	1-G-T...	●	●	●			
2	16	15-14*	20×15×140	2-GHS	●	32	3.5	14	2-G-N...	●	●	●	●	●	19	2-G-T...	●	●	●			
3	18	17-16*	25×18×160	3-GHS	●	41	4	17	3-G-N...	●	●	●	●	●	24	3-G-T...	●	●	●			

▲ Please indicate here the alloy or grade of carbide required ▲

* When requiring intermediate measures, please indicate height of center or of shank (quick change tool posts), e.g. 1-GHS-h.-center 12 or 1-GHS-h.-shank 12.

Availability: ● ex stock / ○ within short notice

