

D **Maschinengewindebohrer**
Speedtap 4.0-Uni/Inox,
gerade genutet, für metrisches
ISO-Feingewinde DIN 13

Einsatzbereich:
HSSE-PM Gewindebohrer für Durchgangsgewinde.
Besonders geeignet für rostfreie Cr-Ni-Stähle,
unlegierten und legierten Stahl ≤ 1300 N/mm².
Die Generation 4.0 setzt neue Maßstäbe beim
Gewinden.

E **Machine taps**
Speedtap 4.0-Uni/Inox,
straight fluted, for metric
ISO-fine threads DIN 13

Range of application:
Tap made of powder steel for through hole
threads. Especially suitable for stainless Cr-Ni
steels, non-alloyed and alloyed steels ≤ 1300
N/mm². The generation 4.0 sets new standards
in threading.

I **Maschi a macchina**
Speedtap 4.0-Uni/Inox,
scanalature diritte, per filettatura
metrica ISO fine, DIN 13

Impiego:
Maschi in acciaio sinterizzato HSSE-PM per fori
passanti. Particolarmente adatti per acciai inossidabili
Cr-Ni, acciai legati e non legati ≤ 1300 N/mm². La nuova
generazione 4.0 stabilisce nuovi standard per realizzare
maschiature.

Speedtap 4.0

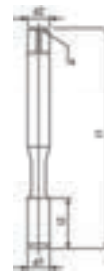

HARDOUR

d1 mm	P mm	l1 mm	l2 mm	d2 _{h9} mm	a _{h12} mm	Z		Code 4609 Art.-Nr.
MF 8	1	90	22	6	4,9	3	0 7	0 4609022001 00
MF 10	1	90	20	7	5,5	3	0 9	0 4609024001 00
MF 10	1,25	100	24	7	5,5	3	0 8,80	0 4609037001 00
MF 12	1	100	22	9	7	3	0 11	0 4609026001 00
MF 12	1,25	100	22	9	7	3	0 10,80	0 4609038001 00
MF 12	1,5	100	22	9	7	3	0 10,5	0 4609040001 00
MF 14	1,5	100	22	11	9	4	0 12,5	0 4609041001 00
MF 16	1,5	100	22	12	9	4	0 14,5	0 4609043001 00
MF 18	1,5	110	25	14	11	4	0 16,5	0 4609044001 00
MF 20	1,5	125	25	16	12	4	0 18,5	0 4609045001 00

D Maschinengewindebohrer
Speedtap 4.0–Uni/Inox,
 spiral-genutet, für metrisches
 ISO-Feingewinde DIN 13

E Machine taps
Speedtap 4.0–Uni/Inox,
 spiral fluted, for metric
 ISO-fine threads DIN 13

I Maschi a macchina
Speedtap 4.0–Uni/Inox,
 scanalature elicoidali, per
 filettatura metrica ISO fine, DIN 13

Einsatzbereich:

HSSE-PM Gewindebohrer für Grundgewinde.
 Besonders geeignet für rostfreie Cr-Ni-Stähle,
 unlegierten und legierten Stahl ≤1300 N/mm².
 Die Generation 4.0 setzt neue Maßstäbe beim
 Gewinden.

Range of application:

Tap made of powder steel for blind hole threads.
 Especially suitable for stainless Cr-Ni steels,
 non-alloyed and alloyed steels ≤1300 N/mm².
 The generation 4.0 sets new standards in
 threading.

Impiego:

Maschi in acciaio sinterizzato HSSE-PM per fori
 ciechi. Particolarmente adatti per acciai inossidabili
 Cr-Ni, acciai legati e non legati ≤1300 N/mm². La
 nuova generazione 4.0 stabilisce nuovi standard per
 realizzare maschiature.

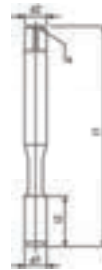

d1 mm	P mm	l1 mm	l2 mm	d2 _{h9} mm	ø _{h12} mm	Z		Code 4619 Art.-Nr.
MF 8	1	90	10	6	4,9	3	Ø 7	0 4619022001 00
MF 10	1	90	12	7	5,5	4	Ø 9	0 4619024001 00
MF 10	1,25	100	12	7	5,5	4	Ø 8,80	0 4619037001 00
MF 12	1	100	14	9	7	4	Ø 11	0 4619026001 00
MF 12	1,25	100	14	9	7	4	Ø 10,80	0 4619038001 00
MF 12	1,5	100	14	9	7	4	Ø 10,5	0 4619040001 00
MF 14	1,5	100	16	11	9	4	Ø 12,5	0 4619041001 00
MF 16	1,5	100	16	12	9	5	Ø 14,5	0 4619043001 00
MF 18	1,5	110	20	14	11	5	Ø 16,5	0 4619044001 00
MF 20	1,5	125	20	16	12	5	Ø 18,5	0 4619045001 00

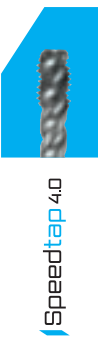

D Maschinengewindebohrer Speedtap 4.0–Ultra Hard Steel 53 HRC,
gerade genutet, für metrisches ISO-Feingewinde DIN 13

Einsatzbereich:
HSSE-PM Gewindebohrer für Durchgangs- und Grundgewinde. Besonders geeignet für zähe und schwer zerspanbare Werkstoffe ≤53HRC. Die Generation 4.0 setzt neue Maßstäbe beim Gewinden.

E Machine taps Speedtap 4.0–Ultra Hard steel 53 HRC,
straight fluted, for metric ISO-fine threads DIN 13

Range of application:
Tap made of powder steel for through hole threads and blind hole threads. Especially suitable for tough and difficult to machine materials ≤53HRC. The generation 4.0 sets new standards in threading.

I Maschi a macchina Speedtap 4.0–Ultra Hard steel 53 HRC,
scanalature diritte, per filettatura metrica ISO fine, DIN 13

Impiego:
Maschi in acciaio sinterizzato HSSE-PM per fori passanti e fori ciechi. Particolarmente adatti per materiali duri e tenaci difficili da lavorare ≤53HRC. La nuova generazione 4.0 stabilisce nuovi.

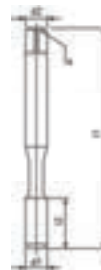

TiCN

d1 mm	P mm	l1 mm	l2 mm	d2 _{h9} mm	a _{h12} mm	Z		Code 4617 Art.-Nr.
MF 8	0,75	70	22	6	4,9	5	Ø 7,4	0 4617080751 00
MF 8	1	70	22	6	4,9	5	Ø 7,4	0 4617081001 00
MF 10	1	75	24	7	5,5	5	Ø 9,1	0 4617101001 00
MF 12	1,5	82	29	9	7	5	Ø 10,6	0 4617121501 00
MF 14	1,5	88	30	11	9	5	Ø 12,6	0 4617141501 00
MF 16	1,5	95	32	12	9	5	Ø 14,6	0 4617161501 00

Schneidöl / Cutting oil / Olio da taglio

Menge / Quantity / Quantità ml	Code 4601 Art.-Nr.
50	0 4601000011 00
125	0 4601000021 00
500	0 4601000031 00

D Maschinengewindebohrer
Speedtap 4.0-Ultra Hard
Steel 63 HRC,
 gerade genutet, für metrisches
 ISO-Feingewinde DIN 13

E Machine taps
Speedtap 4.0-Ultra Hard
steel 63 HRC,
 straight fluted, for metric
 ISO-fine threads DIN 13

I Maschi a macchina
Speedtap 4.0-Ultra Hard
steel 63 HRC,
 scanalature diritte, per filettatura
 metrica ISO fine, DIN 13

Einsatzbereich:

VHM Gewindebohrer für Durchgangs- und Grundgewinde. Besonders geeignet für zähe und schwer zerspanbare Werkstoffe sowie Hartbearbeitung ≤63HRC. Die Generation 4.0 setzt neue Maßstäbe beim Gewinden.

Range of application:

Solid carbide tap for through hole threads and blind hole threads. Especially suitable for tough and difficult to machine materials as well as hard machining ≤63HRC. The generation 4.0 sets new standards in threading.

Impiego:

Maschi in metallo duro per fori passanti e fori ciechi. Particolarmente adatti per materiali duri e tenaci difficili da lavorare oltre che per materiali temprati ≤63HRC. La nuova generazione 4.0 stabilisce nuovi standard per realizzare maschiature.

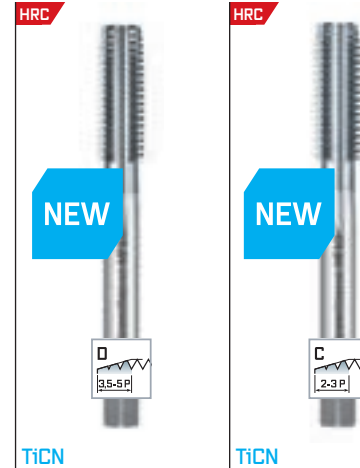

d1 mm	P mm	l1 mm	l2 mm	d2 _{h9} mm	a _{h12} mm	Z		Code 4645 Art.-Nr.	Code 4655 Art.-Nr.
MF 8	1	70	22	6	4,9	5	∅ 7,1	0 4645081001 00	0 4655081001 00
MF 10	1	75	24	7	5,5	5	∅ 9,1	0 4645101001 00	0 4655101001 00
MF 12	1	82	29	9	7	5	∅ 11,1	0 4645121001 00	0 4655121001 00
MF 12	1,5	82	29	9	7	5	∅ 10,6	0 4645121501 00	0 4655121501 00
MF 14	1,5	88	30	11	9	6	∅ 12,6	0 4645141501 00	0 4655141501 00
MF 16	1,5	95	32	12	9	6	∅ 14,6	0 4645161501 00	0 4655161501 00
MF 20	1,5	105	37	16	12	6	∅ 18,6	0 4645201501 00	0 4655201501 00

Schneidöl / Cutting oil / Olio da taglio

Menge/Quantity/Quantità ml	Code 4601 Art.-Nr.
50	0 4601000011 00
125	0 4601000021 00
500	0 4601000031 00



Speedtap 4.0

D **Maschinengewindebohrer**
Speedtap-Universal,
gerade genutet, für metrisches
ISO-Feingewinde DIN 13

Einsatzbereich:
HSSE Gewindebohrer für Durchgangsgewinde.
Besonders geeignet für unlegierte, und legierte
Stähle $\leq 850 \text{ N/mm}^2$ sowie Cu- und Al Legierungen
Si $\leq 10\%$.

Speedtap



E **Machine taps**
Speedtap-Universal,
straight fluted, for metric
ISO-fine threads DIN 13

Impiego:
HSS Cobalt tap for through hole threads.
Especially suitable for non-alloyed and alloyed
steels $\leq 850 \text{ N/mm}^2$ and for copper and aluminium
alloys Si $\leq 10\%$.

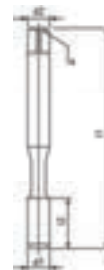

I **Maschi a macchina**
Speedtap-Universal,
scanalature diritte, per filettatura
metrica ISO fine, DIN 13

Impiego:
Maschi in acciaio super rapido al Cobalto HSSE
per fori passanti. Particolarmente adatti per acciai
legati e non legati $\leq 850 \text{ N/mm}^2$ e per leghe di rame e
alluminio Si $\leq 10\%$.



d1 mm	P mm	l1 mm	l2 mm	d2 _{h9} mm	a _{h12} mm	Z		Code 4703 Art.-Nr.
MF 3	0,35	56	8	2,2	-	3	Ø 2,65	0 4703006001 00
MF 4	0,5	63	10	2,8	2,1	3	Ø 3,5	0 4703009001 00
MF 5	0,5	70	12	3,5	2,7	3	Ø 4,5	0 4703011001 00
MF 6	0,5	80	14	4,5	3,4	3	Ø 5,5	0 4703013001 00
MF 6	0,75	80	14	4,5	3,4	3	Ø 5,25	0 4703015001 00
MF 7	0,75	80	14	5,5	4,3	3	Ø 6,25	0 4703016001 00
MF 8	0,5	80	18	6	4,9	3	Ø 7,5	0 4703014001 00
MF 8	0,75	80	18	6	4,9	3	Ø 7,25	0 4703017001 00
MF 8	1	90	22	6	4,9	3	Ø 7	0 4703022001 00
MF 9	1	90	22	7	5,5	3	Ø 8	0 4703023001 00
MF 10	0,75	90	20	7	5,5	3	Ø 9,25	0 4703019001 00
MF 10	1	90	20	7	5,5	3	Ø 9	0 4703024001 00
MF 10	1,25	100	24	7	5,5	3	Ø 8,75	0 4703037001 00
MF 11	1	90	20	8	6,2	3	Ø 10	0 4703025001 00
MF 12	1	100	22	9	7	3	Ø 11	0 4703026001 00
MF 12	1,25	100	22	9	7	3	Ø 10,75	0 4703038001 00
MF 12	1,5	100	22	9	7	3	Ø 10,5	0 4703040001 00
MF 14	1	100	22	11	9	3	Ø 13	0 4703027001 00
MF 14	1,25	100	22	11	9	3	Ø 12,75	0 4703039001 00
MF 14	1,5	100	22	11	9	3	Ø 12,5	0 4703041001 00
MF 15	1	100	22	12	9	3	Ø 14	0 4703028001 00
MF 15	1,5	100	22	12	9	3	Ø 13,5	0 4703042001 00
MF 16	1	100	22	12	9	3	Ø 15	0 4703029001 00
MF 16	1,5	100	22	12	9	3	Ø 14,5	0 4703043001 00
MF 18	1	110	25	14	11	3	Ø 17	0 4703030001 00
MF 18	1,5	110	25	14	11	3	Ø 16,5	0 4703044001 00
MF 18	2	125	34	14	11	3	Ø 16	0 4703065001 00
MF 20	1	125	25	16	12	3	Ø 19	0 4703031001 00
MF 20	1,5	125	25	16	12	3	Ø 18,5	0 4703045001 00
MF 20	2	140	34	16	12	3	Ø 18	0 4703066001 00
MF 22	1	125	25	18	14,5	3	Ø 21	0 4703032001 00
MF 22	1,5	125	25	18	14,5	3	Ø 20,5	0 4703046001 00

d1 mm	P mm	l1 mm	l2 mm	d2 _{h9} mm	ø _{h12} mm	Z		Code 4703 Art.-Nr.
MF 22	2	140	34	18	14,5	3	Ø 20	0 4703067001 00
MF 24	1	140	28	18	14,5	3	Ø 23	0 4703033001 00
MF 24	1,5	140	28	18	14,5	3	Ø 22,5	0 4703047001 00
MF 24	2	140	28	18	14,5	3	Ø 22	0 4703068001 00
MF 25	1,5	140	28	18	14,5	3	Ø 23,5	0 4703048001 00
MF 26	1,5	140	28	18	14,5	4	Ø 24,5	0 4703049001 00
MF 27	1,5	140	28	20	16	4	Ø 25,5	0 4703050001 00
MF 27	2	140	28	20	16	4	Ø 25	0 4703069001 00
MF 28	1,5	140	28	20	16	4	Ø 26,5	0 4703051001 00
MF 30	1	150	28	22	18	4	Ø 29	0 4703034001 00
MF 30	1,5	150	28	22	18	4	Ø 28,5	0 4703052001 00
MF 30	2	150	28	22	18	4	Ø 28	0 4703070001 00
MF 32	1,5	150	28	22	18	4	Ø 30,5	0 4703053001 00
MF 33	1,5	160	30	25	20	4	Ø 31,5	0 4703052501 00
MF 34	1,5	170	30	28	22	4	Ø 32,5	0 4703054001 00
MF 35	1,5	170	30	28	22	4	Ø 33,5	0 4703056001 00
MF 36	1,5	170	30	28	22	4	Ø 34,5	0 4703057001 00
MF 38	1,5	170	30	28	22	4	Ø 36,5	0 4703058001 00
MF 40	1,5	170	30	32	24	4	Ø 38,5	0 4703059001 00
MF 42	1,5	170	30	32	24	4	Ø 40,5	0 4703060001 00
MF 45	1,5	180	32	36	29	4	Ø 43,5	0 4703061001 00
MF 48	1,5	190	32	36	29	4	Ø 46,5	0 4703062001 00
MF 50	1,5	190	32	36	29	4	Ø 48,5	0 4703063001 00
MF 52	1,5	190	32	40	32	4	Ø 50,5	0 4703064001 00



D **Maschinengewindebohrer Speedtap-Uni/Inox,**
gerade genutet, für metrisches ISO-Feingewinde DIN 13

E **Machine taps Speedtap-Uni/Inox,**
straight fluted, for metric ISO-fine threads DIN 13

I **Maschi a macchina Speedtap-Uni/Inox,**
scanalature diritte, per filettatura metrica ISO fine, DIN 13

Einsatzbereich:
HSSE-PM Gewindebohrer für Durchgangsgewinde. Besonders geeignet für unlegierte, legierte sowie rostfreie Cr-Ni-Stähle ≤1300 N/mm².

Range of application:
Tap made of powder steel for through hole threads. Especially suitable for non-alloyed and alloyed steels and for stainless Cr-Ni-steels ≤1300 N/mm².

Impiego:
Maschi in acciaio sinterizzato HSSE-PM per fori passanti. Particolarmente adatti per acciai legati e non legati e per acciai inossidabili Cr-Ni ≤1300 N/mm².

Speedtap



Uni Inox



HARDOUR

d1 mm	P mm	l1 mm	l2 mm	d2 _{h9} mm	a _{h12} mm	Z		Code 4753 Art.-Nr.
MF 8	1	90	22	6	4,9	3	Ø 7	0 4753022001 00
MF 10	1	90	20	7	5,5	3	Ø 9	0 4753024001 00
MF 10	1,25	100	24	7	5,5	3	Ø 8,8	0 4753037001 00
MF 12	1	100	22	9	7	3	Ø 11	0 4753026001 00
MF 12	1,25	100	22	9	7	3	Ø 10,8	0 4753038001 00
MF 12	1,5	100	22	9	7	3	Ø 10,5	0 4753040001 00
MF 14	1,5	100	22	11	9	4	Ø 12,5	0 4753041001 00
MF 16	1,5	100	22	12	9	4	Ø 14,5	0 4753043001 00
MF 18	1,5	110	25	14	11	4	Ø 16,5	0 4753044001 00
MF 20	1,5	125	25	16	12	4	Ø 18,5	0 4753045001 00

D Maschinengewindebohrer
Speedtap-Universal,
spiral-genutet, für metrisches
ISO-Feingewinde DIN 13

Einsatzbereich:

HSSE Gewindebohrer für Grundgewinde.
Besonders geeignet für unlegierte, und legierte
Stähle $\leq 850 \text{ N/mm}^2$ sowie Cu- und Al Legierungen
Si $\leq 10\%$.

Speedtap



E Machine taps
Speedtap-Universal,
spiral fluted, for metric
ISO-fine threads DIN 13

Impiego:

HSS Cobalt tap for blind hole threads. Especially
suitable for non-alloyed and alloyed steels ≤ 850
N/mm² and for copper and aluminium alloys Si
 $\leq 10\%$.



I Maschi a macchina
Speedtap-Universal,
scanalature elicoidali, per
filettatura metrica ISO fine, DIN 13

Impiego:

Maschi in acciaio super rapido al Cobalto HSSE per
fori ciechi. Particolarmente adatti per acciai legati e
non legati $\leq 850 \text{ N/mm}^2$ e per leghe di rame e allu-
minio Si $\leq 10\%$.



d1 mm	P mm	l1 mm	l2 mm	d2 _{h9} mm	a _{h12} mm	Z		Code 4713 Art.-Nr.
MF 3	0,35	56	4	2,2	-	3	Ø 2,65	0 4713006001 00
MF 4	0,5	63	6	2,8	2,1	3	Ø 3,5	0 4713009001 00
MF 5	0,5	70	7	3,5	2,7	3	Ø 4,5	0 4713011001 00
MF 6	0,5	80	8	4,5	3,4	3	Ø 5,5	0 4713013001 00
MF 6	0,75	80	8	4,5	3,4	3	Ø 5,25	0 4713015001 00
MF 8	0,75	80	10	6	4,9	3	Ø 7,25	0 4713017001 00
MF 8	1	90	10	6	4,9	3	Ø 7	0 4713022001 00
MF 10	1	90	12	7	5,5	3	Ø 9	0 4713024001 00
MF 10	1,25	100	12	7	5,5	3	Ø 8,8	0 4713037001 00
MF 12	1	100	14	9	7	3	Ø 11	0 4713026001 00
MF 12	1,25	100	14	9	7	3	Ø 10,8	0 4713038001 00
MF 12	1,5	100	14	9	7	3	Ø 10,5	0 4713040001 00
MF 14	1	100	16	11	9	3	Ø 13	0 4713027001 00
MF 14	1,25	100	16	11	9	3	Ø 12,8	0 4713039001 00
MF 14	1,5	100	16	11	9	3	Ø 12,5	0 4713041001 00
MF 16	1	100	16	12	9	3	Ø 15	0 4713029001 00
MF 16	1,5	100	16	12	9	3	Ø 14,5	0 4713043001 00
MF 18	1	110	20	14	11	4	Ø 17	0 4713030001 00
MF 18	1,5	110	20	14	11	4	Ø 16,5	0 4713044001 00
MF 20	1	125	20	16	12	4	Ø 19	0 4713031001 00
MF 20	1,5	125	20	16	12	4	Ø 18,5	0 4713045001 00
MF 22	1,5	125	20	18	14,5	4	Ø 20,5	0 4713046001 00
MF 24	1,5	140	24	18	14,5	4	Ø 22,5	0 4713047001 00
MF 24	2	140	24	18	14,5	4	Ø 22	0 4713068001 00
MF 25	1,5	140	24	18	14,5	4	Ø 23,5	0 4713048001 00
MF 26	1,5	140	24	18	14,5	4	Ø 24,5	0 4713049001 00
MF 27	1,5	140	24	20	16	4	Ø 25,5	0 4713050001 00
MF 27	2	140	24	20	16	4	Ø 25	0 4713069001 00
MF 28	1,5	140	24	20	16	4	Ø 26,5	0 4713051001 00
MF 30	1,5	150	28	22	18	4	Ø 28,5	0 4713052001 00
MF 30	2	150	28	22	18	4	Ø 28	0 4713070001 00

D **Maschinengewindebohrer**
Speedtap-Uni/Inox,
spiral-genutet, für metrisches
ISO-Feingewinde DIN 13

E **Machine taps**
Speedtap-Uni/Inox,
spiral fluted, for metric
ISO-fine threads DIN 13

I **Maschi a macchina**
Speedtap-Uni/Inox,
scanalature elicoidali, per
filettatura metrica ISO fine, DIN 13

Einsatzbereich:
HSSE-PM Gewindebohrer für Grundgewinde.
Besonders geeignet für unlegierte, legierte sowie
rostfreie Cr-Ni-Stähle ≤1300 N/mm².

Range of application:
Tap made of powder steel for blind hole threads.
Especially suitable for non-alloyed and alloyed
steels and for stainless Cr-Ni-steels ≤1300 N/mm².

Impiego:
Maschi in acciaio sinterizzato HSSE-PM per fori
ciechi. Particolarmente adatti per acciai legati e non
legati e per acciai inossidabili Cr-Ni ≤1300 N/mm².

Speedtap

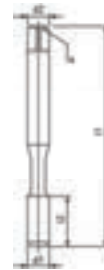

HARDOUR

d1 mm	P mm	l1 mm	l2 mm	d2 _{h9} mm	a _{h12} mm	Z		Code 4763 Art.-Nr.
MF 8	1	90	10	6	4,9	3	Ø 7	0 4763022001 00
MF 10	1	90	12	7	5,5	4	Ø 9	0 4763024001 00
MF 10	1,25	100	12	7	5,5	4	Ø 8,8	0 4763037001 00
MF 12	1	100	14	9	7	4	Ø 11	0 4763026001 00
MF 12	1,25	100	14	9	7	4	Ø 10,8	0 4763038001 00
MF 12	1,5	100	14	9	7	4	Ø 10,5	0 4763040001 00
MF 14	1,5	100	16	11	9	4	Ø 12,5	0 4763041001 00
MF 16	1,5	100	16	12	9	5	Ø 14,5	0 4763043001 00
MF 18	1,5	110	20	14	11	5	Ø 16,5	0 4763044001 00
MF 20	1,5	125	20	16	12	5	Ø 18,5	0 4763045001 00

D Maschinengewindebohrer
Speedtap-Inox,
gerade genutet, für metrisches
ISO-Feingewinde DIN 13

E Machine taps
Speedtap-Inox,
straight fluted, for metric
ISO-fine threads DIN 13

I Maschi a macchina
Speedtap-Inox,
scanalature diritte, per filettatura
metrica ISO fine, DIN 13

Einsatzbereich:

HSSE Gewindebohrer für Durchgangsgewinde.
Besonders geeignet für unlegierte, legierte sowie
rostfreie Cr-Ni-Stähle $\leq 1200 \text{ N/mm}^2$.

Range of application:

HSS Cobalt tap for through hole threads. Especially
suitable for non-alloyed and alloyed steels and for
stainless Cr-Ni-steels $\leq 1200 \text{ N/mm}^2$.

Impiego:

Maschi in acciaio super rapido al Cobalto HSSE per fori
passanti. Particolarmente adatti per acciai legati e non
legati e per acciai inossidabili Cr-Ni $\leq 1200 \text{ N/mm}^2$.

Speedtap

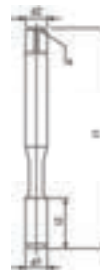

Inox



VAPD

d1 mm	P mm	l1 mm	l2 mm	d2 _{h9} mm	a _{h12} mm	Z		Code 4723 Art.-Nr.
MF 3	0,35	56	8	2,2	-	3	0 2,65	0 4723006001 00
MF 4	0,5	63	10	2,8	2,1	3	0 3,5	0 4723009001 00
MF 5	0,5	70	12	3,5	2,7	3	0 4,5	0 4723011001 00
MF 6	0,5	80	14	4,5	3,4	3	0 5,5	0 4723013001 00
MF 6	0,75	80	14	4,5	3,4	3	0 5,25	0 4723015001 00
MF 8	0,75	80	18	6	4,9	3	0 7,25	0 4723017001 00
MF 8	1	90	22	6	4,9	3	0 7	0 4723022001 00
MF 10	1	90	20	7	5,5	3	0 9	0 4723024001 00
MF 12	1	100	22	9	7	3	0 11	0 4723026001 00
MF 12	1,5	100	22	9	7	3	0 10,5	0 4723040001 00
MF 14	1,5	100	22	11	9	3	0 12,5	0 4723041001 00
MF 16	1,5	100	22	12	9	3	0 14,5	0 4723043001 00
MF 18	1,5	110	25	14	11	3	0 16,5	0 4723044001 00
MF 20	1,5	125	25	16	12	3	0 18,5	0 4723045001 00
MF 22	1,5	125	25	18	14,5	3	0 20,5	0 4723046001 00
MF 24	1,5	140	28	18	14,5	3	0 22,5	0 4723047001 00

D Maschinengewindebohrer Speedtap-Inox,
spiral-genutet, für metrisches ISO-Feingewinde DIN 13

E Machine taps Speedtap-Inox,
spiral fluted, for metric ISO-fine threads DIN 13

I Maschi a macchina Speedtap-Inox,
scanalature elicoidali, per filettatura metrica ISO fine, DIN 13

Einsatzbereich:
HSSE Gewindebohrer für Grundgewinde. Besonders geeignet für unlegierte, legierte sowie rostfreie Cr-Ni-Stähle $\leq 1200 \text{ N/mm}^2$.

Range of application:
HSS Cobalt tap for blind hole threads. Especially suitable for non-alloyed and alloyed steels and for stainless Cr-Ni-steels $\leq 1200 \text{ N/mm}^2$.

Impiego:
Maschi in acciaio super rapido al Cobalto HSSE per fori ciechi. Particolarmente adatti per acciai legati e non legati e per acciai inossidabili Cr-Ni $\leq 1200 \text{ N/mm}^2$.

Speedtap

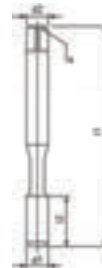

VAPD

d1 mm	P mm	l1 mm	l2 mm	d2 _{h9} mm	a _{h12} mm	Z		Code 4733 Art.-Nr.
MF 3	0,35	56	4	2,2	-	3	Ø 2,65	0 4733006001 00
MF 4	0,5	63	6	2,8	2,1	3	Ø 3,5	0 4733009001 00
MF 5	0,5	70	7	3,5	2,7	3	Ø 4,5	0 4733011001 00
MF 6	0,5	80	8	4,5	3,4	3	Ø 5,5	0 4733013001 00
MF 6	0,75	80	8	4,5	3,4	3	Ø 5,25	0 4733015001 00
MF 8	0,75	80	10	6	4,9	3	Ø 7,25	0 4733017001 00
MF 8	1	90	10	6	4,9	3	Ø 7	0 4733022001 00
MF 10	1	90	12	7	5,5	4	Ø 9	0 4733024001 00
MF 12	1	100	14	9	7	4	Ø 11	0 4733026001 00
MF 12	1,5	100	14	9	7	4	Ø 10,5	0 4733040001 00
MF 14	1,5	100	16	11	9	4	Ø 12,5	0 4733041001 00
MF 16	1,5	100	16	12	9	5	Ø 14,5	0 4733043001 00
MF 18	1,5	110	20	14	11	5	Ø 16,5	0 4733044001 00
MF 20	1,5	125	20	16	12	5	Ø 18,5	0 4733045001 00
MF 22	1,5	125	20	18	14,5	5	Ø 20,5	0 4733046001 00
MF 24	1,5	140	24	18	14,5	5	Ø 22,5	0 4733047001 00
MF 27	1,5	140	24	20	16	5	Ø 25,5	0 4733050001 00
MF 30	1,5	150	28	22	18	5	Ø 28,5	0 4733052001 00

D **Maschinengewindebohrer**
Speedtap–Grauguss,
 gerade genutet, für metrisches
 ISO-Feingewinde DIN 13

E **Machine taps**
Speedtap–Grauguss,
 straight fluted, for metric
 ISO-fine threads DIN 13

I **Maschi a macchina**
Speedtap–Grauguss,
 scanalature diritte, per filettatura
 metrica ISO fine, DIN 13

Einsatzbereich:

HSSE Gewindebohrer für Durchgangsgewinde.
 Besonders geeignet für alle Gußeisen (Grauguß,
 Kugelgraphitguß, Temperguß, Vermikularguß,
 ADI, Hartguß).

Range of application:

HSS Cobalt tap for through hole threads. Especially
 suitable for all cast iron (grey cast iron, spheroidal
 graphite, malleable cast iron, vermicular, ADI,
 chilled iron).

Impiego:

Maschi in acciaio super rapido al Cobalto HSSE per
 fori passanti. Particolarmente adatti per tutti i tipi di
 ghisa (ghisa grigia, ghisa sferoidale, ghisa temprata,
 ghisa vermiculare, ADI, ghisa temperata).

Speedtap

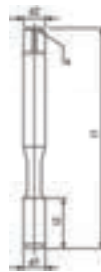

Cast Iron



TiCN

d1 mm	P mm	l1 mm	l2 mm	d2 _{h9} mm	a _{h12} mm	Z		Code 4743 Art.-Nr.
MF 8	1	90	22	6	4,9	4	Ø 7	0 4743022001 00
MF 10	1	90	20	7	5,5	4	Ø 9	0 4743024001 00
MF 12	1,5	100	22	9	7	4	Ø 10,5	0 4743040001 00
MF 16	1,5	100	22	12	9	4	Ø 14,5	0 4743043001 00



Speedtap 4.0

D Maschinengewindeformer Speedtap-Universal, mit Ölnuten, für metrisches ISO-Feingewinde DIN 13

Einsatzbereich:
HSSE Gewindeformer für Durchgangs- und Grundgewinde. Besonders geeignet für unlegierte, und legierte Stähle $\leq 1300 \text{ N/mm}^2$, Aluminium Si $\leq 10\%$.

Speedtap

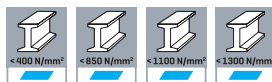

E Rolling taps Speedtap-Universal, with oil grooves, for metric ISO-fine threads DIN 13

Range of application:
HSS Cobalt rolling tap for through hole threads and blind hole threads. Especially suitable for non-alloyed and alloyed steels $\leq 1300 \text{ N/mm}^2$, aluminium Si $\leq 10\%$.



I Maschi a macchina a rulare Speedtap-Universal, con scanalature per lubrificazione, per filettatura metrica ISO fine, DIN 13

Impiego:
Maschi a rulare in acciaio super rapido al Cobalto HSSE per fori passanti e fori ciechi. Particolarmente adatti per acciai legati e non legati $\leq 1300 \text{ N/mm}^2$, alluminio Si $\leq 10\%$.



d1 mm	P mm	l1 mm	l2 mm	l3 mm	d2 _{h9} mm	a _{h12} mm	Z		Code 4773 Art.-Nr.
MF 8	1	90	10	35	8	6,2	5	0 7,55	0 4773022001 00
MF 10	1	90	12	35	10	8	8	0 9,55	0 4773024001 00
MF 10	1,25	100	12	39	10	8	8	0 9,45	0 4773037001 00
MF 12	1	100	15	-	9	7	8	0 11,6	0 4773026001 00
MF 12	1,25	100	15	-	9	7	8	0 11,4	0 4773038001 00
MF 12	1,5	100	15	-	9	7	8	0 11,3	0 4773040001 00
MF 14	1,25	100	15	-	11	9	8	0 13,4	0 4773039001 00
MF 14	1,5	100	15	-	11	9	8	0 13,3	0 4773041001 00
MF 16	1,5	100	15	-	12	9	8	0 15,3	0 4773043001 00
MF 18	1,5	110	15	-	14	11	8	0 17,3	0 4773044001 00
MF 20	1,5	125	15	-	16	12	8	0 19,3	0 4773045001 00
MF 22	1,5	125	15	-	18	14,5	8	0 21,3	0 4773046001 00
MF 24	1,5	140	15	-	18	14,5	8	0 23,3	0 4773047001 00

D Maschinengewindeformer Speedtap-Inox,
mit Ölnuten, für metrisches ISO-Feingewinde DIN 13

E Rolling taps Speedtap-Inox,
with oil grooves, for metric ISO-fine threads DIN 13

I Maschi a macchina a rulare Speedtap-Inox,
con scanalature per lubrificazione, per filettatura metrica ISO fine, DIN 13

Einsatzbereich:
HSSE Gewindeformer für Durchgangs- und Grundgewinde. Besonders geeignet für rostfreie Cr-Ni-Stähle ≤ 1200 N/mm², Aluminium Si $\leq 10\%$.

Range of application:
HSS Cobalt rolling tap for through hole threads and blind hole threads. Especially suitable for stainless Cr-Ni-steels ≤ 1200 N/mm², aluminium Si $\leq 10\%$.

Impiego:
Maschi a rulare in acciaio super rapido al Cobalto HSSE per fori passanti e fori ciechi. Particolarmente adatti per acciai inossidabili Cr-Ni ≤ 1200 N/mm², alluminio Si $\leq 10\%$.

Speedtap



TiN

d1 mm	P mm	l1 mm	l2 mm	l3 mm	d2 _{h9} mm	a _{h12} mm	Z		Code 4783 Art.-Nr.
MF 3	0,35	56	8	18	3,5	2,7	3	∅ 2,85	0 4783006001 00
MF 4	0,5	63	10	21	4,5	3,4	4	∅ 3,9	0 4783009001 00
MF 5	0,5	70	12	25	6	4,9	4	∅ 4,78	0 4783011001 00
MF 6	0,75	80	14	30	6	4,9	5	∅ 5,7	0 4783015001 00
MF 8	1	90	22	35	8	6,2	5	∅ 7,55	0 4783022001 00
MF 10	1	90	20	35	10	8	5	∅ 9,55	0 4783024001 00
MF 12	1,5	100	22	-	9	7	6	∅ 11,3	0 4783040001 00
MF 16	1,5	100	22	-	12	9	6	∅ 15,3	0 4783043001 00



Speedtap 4.0