

D Maschinengewindebohrer
Speedtap 4.0–Uni/Inox,
 gerade genutet, für Whitworth-
 Rohrgewinde DIN ISO 228

E Machine taps
Speedtap 4.0–Uni/Inox,
 straight fluted, for whitworth
 pipe threads DIN ISO 228

I Maschi a macchina
Speedtap 4.0–Uni/Inox,
 scanalature diritte, per filettatura
 whitworth per tubi, DIN ISO 228

Einsatzbereich:
 HSSE-PM Gewindebohrer für Durchgangsgewinde.
 Besonders geeignet für rostfreie Cr-Ni-Stähle,
 unlegierten und legierten Stahl ≤ 1300 N/mm².
 Die Generation 4.0 setzt neue Maßstäbe beim
 Gewinden.

Range of application:
 Tap made of powder steel for through hole
 threads. Especially suitable for stainless Cr-Ni
 steels, non-alloyed and alloyed steels ≤ 1300
 N/mm². The generation 4.0 sets new standards
 in threading.

Impiego:
 Maschi in acciaio sinterizzato HSSE-PM per fori
 passanti. Particolarmente adatti per acciai inossidabili
 Cr-Ni, acciai legati e non legati ≤ 1300 N/mm². La
 nuova generazione 4.0 stabilisce nuovi standard per
 realizzare maschiature.

Speedtap 4.0



HARDOUR

d1 inch	P Gg / 1"	l1 mm	l2 mm	d2 _{h9} mm	a _{h12} mm	Z		Code 4772 Art.-Nr.
G 1/8"	28	90	20	7	5,5	3	Ø 8,8	0 4772016001 00
G 1/4"	19	100	21	11	9	3	Ø 11,8	0 4772020001 00
G 3/8"	19	100	22	12	9	3	Ø 15,25	0 4772024001 00
G 1/2"	14	125	24	16	12	3	Ø 19	0 4772028001 00
G 5/8"	14	125	25	18	14,5	4	Ø 21	0 4772032001 00
G 3/4"	14	140	26	20	16	4	Ø 24,5	0 4772034001 00
G 1"	11	160	30	25	20	4	Ø 30,75	0 4772038001 00

D Maschinengewindebohrer
Speedtap 4.0–Uni/Inox,
 spiral-genutet, für Whitworth-
 Rohrgewinde DIN ISO 228

E Machine taps
Speedtap 4.0–Uni/Inox,
 spiral fluted, for whitworth
 pipe threads DIN ISO 228

I Maschi a macchina
Speedtap 4.0–Uni/Inox,
 scanalature elicoidali, per filettatura
 whitworth per tubi, DIN ISO 228

Einsatzbereich:

HSSE-PM Gewindebohrer für Grundgewinde.
 Besonders geeignet für rostfreie Cr-Ni-Stähle,
 unlegierten und legierten Stahl ≤1300 N/mm².
 Die Generation 4.0 setzt neue Maßstäbe beim
 Gewinden.

Range of application:

Tap made of powder steel for blind hole threads.
 Especially suitable for stainless Cr-Ni steels,
 non-alloyed and alloyed steels ≤1300 N/mm².
 The generation 4.0 sets new standards in
 threading.

Impiego:

Maschi in acciaio sinterizzato HSSE-PM per fori
 ciechi. Particolarmente adatti per acciai inossidabili
 Cr-Ni, acciai legati e non legati ≤1300 N/mm². La
 nuova generazione 4.0 stabilisce nuovi standard per
 realizzare maschiature.

Speedtap 4.0

Material compatibility icons:
 - <400 N/mm², <850 N/mm², <1100 N/mm², <1300 N/mm²
 - INOX <850 N/mm², INOX >850 N/mm², GRAUGUSS CAST IRON GHISL GREGAR
 - Ti, Cu, Ms, Al

Technical specifications icons:
 - G
 - HSS E/PM
 - 55° P
 - 50°
 - DIN 5156
 - C 2-3 P
 - Z=3-5

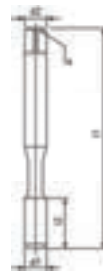

d1 inch	P Gg / 1"	l1 mm	l2 mm	d2 _{h9} mm	a _{h12} mm	Z		Code 4782 Art.-Nr.
G 1/8"	28	90	12	7	5,5	3	Ø 8,8	0 4782016001 00
G 1/4"	19	100	15	11	9	4	Ø 11,8	0 4782020001 00
G 3/8"	19	100	15	12	9	4	Ø 15,25	0 4782024001 00
G 1/2"	14	125	18	16	12	4	Ø 19	0 4782028001 00
G 5/8"	14	125	18	18	14,5	4	Ø 21	0 4782032001 00
G 3/4"	14	140	20	20	16	5	Ø 24,5	0 4782034001 00
G 1"	11	160	22	25	20	5	Ø 30,75	0 4782038001 00



D **Maschinengewindebohrer**
Speedtap 4.0-Ultra Hard
Steel 53 HRC,
gerade genutet, für Whitworth-
Rohrgewinde DIN ISO 228

Einsatzbereich:

HSSE-PM Gewindebohrer für Durchgangs- und Grundgewinde. Besonders geeignet für zähe und schwer zerspanbare Werkstoffe ≤53HRC. Die Generation 4.0 setzt neue Maßstäbe beim Gewinden.

E **Machine taps**
Speedtap 4.0-Ultra Hard
steel 53 HRC,
straight fluted, for whitworth
pipe threads DIN ISO 228

Range of application:

Tap made of powder steel for through hole threads and blind hole threads. Especially suitable for tough and difficult to machine materials ≤53HRC. The generation 4.0 sets new standards in threading.

I **Maschi a macchina**
Speedtap 4.0-Ultra Hard
steel 53 HRC,
scanalature diritte, per filettatura
whitworth per tubi, DIN ISO 228

Impiego:

Maschi in acciaio sinterizzato HSSE-PM per fori passanti e fori ciechi. Particolarmente adatti per materiali duri e tenaci difficili da lavorare ≤53HRC. La nuova generazione 4.0 stabilisce nuovi standard per realizzare maschiature.

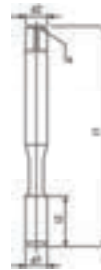

d1 inch	P Gg / 1"	l1 mm	l2 mm	d2 _{h9} mm	a _{h12} mm	Z		Code 4617 Art.-Nr.
G 1/8"	28	63	18	7	5,5	5	Ø 8,8	0 4617317001 00
G 1/4"	19	70	20	11	9	5	Ø 11,9	0 4617635001 00
G 3/8"	19	70	22	12	9	5	Ø 15,4	0 4617952001 00

Schneidöl / Cutting oil / Olio da taglio

Menge / Quantity / Quantità ml	Code 4601 Art.-Nr.
50	0 4601000011 00
125	0 4601000021 00
500	0 4601000031 00

D Maschinengewindebohrer
Speedtap 4.0-Ultra Hard
Steel 63 HRC,
 gerade genutet, für Whitworth-
 Rohrgewinde DIN ISO 228

E Machine taps
Speedtap 4.0-Ultra Hard
steel 63 HRC,
 straight fluted, for whitworth
 pipe threads DIN ISO 228

I Maschi a macchina
Speedtap 4.0-Ultra Hard
steel 63 HRC,
 scanalature diritte, per filettatura
 whitworth per tubi, DIN ISO 228

Einsatzbereich:

VHM Gewindebohrer für Durchgangs- und Grundgewinde. Besonders geeignet für zähe und schwer zerspanbare Werkstoffe sowie Hartbearbeitung ≤63HRC. Die Generation 4.0 setzt neue Maßstäbe beim Gewinden.

Range of application:

Solid carbide tap for through hole threads and blind hole threads. Especially suitable for tough and difficult to machine materials as well as hard machining ≤63HRC. The generation 4.0 sets new standards in threading.

Impiego:

Maschi in metallo duro per fori passanti e fori ciechi. Particolarmente adatti per materiali duri e tenaci difficili da lavorare oltre che per materiali temprati ≤63HRC. La nuova generazione 4.0 stabilisce nuovi standard per realizzare maschiature.

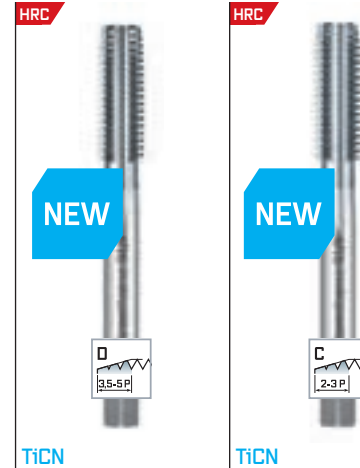

d1 inch	P Gg / 1"	l1 mm	l2 mm	d2 _{h9} mm	a _{h12} mm	Z		Code 4645 Art.-Nr.	Code 4655 Art.-Nr.
G 1/8"	28	63	18	7	5,5	5	0 8,9	0 4645317001 00	0 4655317001 00
G 1/4"	19	70	20	11	9	5	0 11,9	0 4645635001 00	0 4655635001 00

Schneidöl / Cutting oil / Olio da taglio

Menge/Quantity/Quantità ml	Code 4601 Art.-Nr.
50	0 4601000011 00
125	0 4601000021 00
500	0 4601000031 00



D Maschinengewindebohrer
Speedtap-Universal,
gerade genutet, für Whitworth-
Rohrgewinde DIN ISO 228

E Machine taps
Speedtap-Universal,
straight fluted, for whitworth
pipe threads DIN ISO 228

I Maschi a macchina
Speedtap-Universal,
scanalature diritte, per filettatura
whitworth per tubi, DIN ISO 228

Einsatzbereich:
HSSE Gewindebohrer für Durchgangsgewinde.
Besonders geeignet für unlegierte, und legierte
Stähle $\leq 850 \text{ N/mm}^2$ sowie Cu- und Al Legierungen
Si $\leq 10\%$.

Impiego:
HSS Cobalt tap for through hole threads. Especially
suitable for non-alloyed and alloyed steels ≤ 850
 N/mm^2 and for copper and aluminium alloys Si
 $\leq 10\%$.

Impiego:
Maschi in acciaio super rapido al Cobalto HSSE per fori
passanti. Particolarmente adatti per acciai legati e non
legati $\leq 850 \text{ N/mm}^2$ e per leghe di rame e alluminio Si
 $\leq 10\%$.

Speedtap

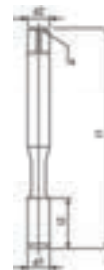
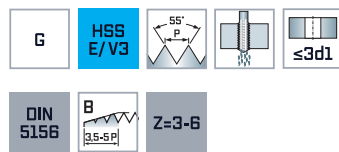
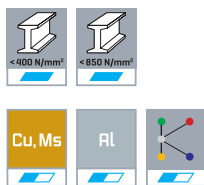

d1 inch	P Gg / 1"	l1 mm	l2 mm	d2 _{h9} mm	a _{h12} mm	Z		Code 4702 Art.-Nr.
G 1/8"	28	90	20	7	5,5	3	Ø 8,8	0 4702016001 00
G 1/4"	19	100	22	11	9	3	Ø 11,8	0 4702020001 00
G 3/8"	19	100	22	12	9	3	Ø 15,25	0 4702024001 00
G 1/2"	14	125	25	16	12	3	Ø 19	0 4702028001 00
G 5/8"	14	125	25	18	14,5	4	Ø 21	0 4702032001 00
G 3/4"	14	140	28	20	16	4	Ø 24,5	0 4702034001 00
G 7/8"	14	150	28	22	18	4	Ø 28,25	0 4702036001 00
G 1"	11	160	30	25	20	4	Ø 30,75	0 4702038001 00
G 1 1/8"	11	170	30	28	22	4	Ø 35,3	0 4702040001 00
G 1 1/4"	11	170	30	32	24	4	Ø 39,25	0 4702042001 00
G 1 3/8"	11	180	32	36	29	6	Ø 41,9	0 4702044001 00
G 1 1/2"	11	190	32	36	29	6	Ø 45,25	0 4702046001 00

D Maschinengewindebohrer Speedtap-Uni/Inox, gerade genutet, für Whitworth-Rohrgewinde DIN ISO 228

E Machine taps Speedtap-Uni/Inox, straight fluted, for whitworth pipe threads DIN ISO 228

I Maschi a macchina Speedtap-Uni/Inox, scanalature diritte, per filettatura whitworth per tubi, DIN ISO 228

Einsatzbereich:
HSSE-PM Gewindebohrer für Durchgangsgewinde. Besonders geeignet für unlegierte, legierte sowie rostfreie Cr-Ni-Stähle ≤1300 N/mm².

Range of application:
Tap made of powder steel for through hole threads. Especially suitable for non-alloyed and alloyed steels and for stainless Cr-Ni-steels ≤1300 N/mm².

Impiego:
Maschi in acciaio sinterizzato HSSE-PM per fori passanti. Particolarmente adatti per acciai legati e non legati e per acciai inossidabili Cr-Ni ≤1300 N/mm².

Speedtap

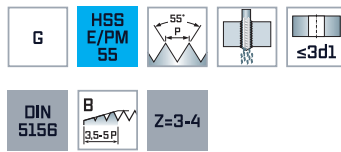

HARDOUR

d1 inch	P Gg / 1"	l1 mm	l2 mm	d2 _{h9} mm	a _{h12} mm	Z		Code 4742 Art.-Nr.
G 1/8"	28	90	20	7	5,5	3	0 8,8	0 4742016001 00
G 1/4"	19	100	22	11	9	3	0 11,8	0 4742020001 00
G 3/8"	19	100	22	12	9	3	0 15,25	0 4742024001 00
G 1/2"	14	125	25	16	12	3	0 19	0 4742028001 00
G 5/8"	14	125	25	18	14,5	4	0 21	0 4742032001 00
G 3/4"	14	140	26	20	16	4	0 24,5	0 4742034001 00
G 1"	11	160	30	25	20	4	0 30,75	0 4742038001 00



Speedtap 4.0

D **Maschinengewindebohrer Speedtap-Universal,** spiral-genutet, für Whitworth-Rohrgewinde DIN ISO 228

E **Machine taps Speedtap-Universal,** spiral fluted, for whitworth pipe threads DIN ISO 228

I **Maschi a macchina Speedtap-Universal,** scanalature elicoidali, per filettatura whitworth per tubi, DIN ISO 228

Einsatzbereich:
HSSE Gewindebohrer für Grundgewinde. Besonders geeignet für unlegierte, und legierte Stähle $\leq 850 \text{ N/mm}^2$ sowie Cu- und Al Legierungen Si $\leq 10\%$.

Impiego:
HSS Cobalt tap for blind hole threads. Especially suitable for non-alloyed and alloyed steels $\leq 850 \text{ N/mm}^2$ and for copper and aluminium alloys Si $\leq 10\%$.

Impiego:
Maschi in acciaio super rapido al Cobalto HSSE per fori ciechi. Particolarmente adatti per acciai legati e non legati $\leq 850 \text{ N/mm}^2$ e per leghe di rame e alluminio Si $\leq 10\%$.

Speedtap

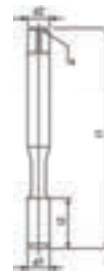
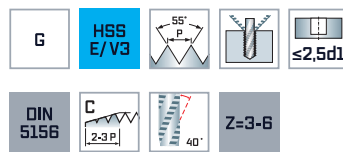
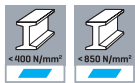

d1 inch	P Gg / 1"	l1 mm	l2 mm	d2 _{h9} mm	a _{h12} mm	Z		Code 4712 Art.-Nr.
G 1/8"	28	90	16	7	5,5	3	Ø 8,8	0 4712016001 00
G 1/4"	19	100	20	11	9	3	Ø 11,8	0 4712020001 00
G 3/8"	19	100	22	12	9	3	Ø 15,25	0 4712024001 00
G 1/2"	14	125	25	16	12	4	Ø 19	0 4712028001 00
G 5/8"	14	125	25	18	14,5	4	Ø 21	0 4712032001 00
G 3/4"	14	140	28	20	16	4	Ø 24,5	0 4712034001 00
G 7/8"	14	150	28	22	18	4	Ø 28,25	0 4712036001 00
G 1"	11	160	30	25	20	4	Ø 30,75	0 4712038001 00
G 1 1/8"	11	170	30	28	22	4	Ø 35,3	0 4712040001 00
G 1 1/4"	11	170	30	32	24	6	Ø 39,25	0 4712042001 00
G 1 3/8"	11	180	32	36	29	6	Ø 41,9	0 4712044001 00
G 1 1/2"	11	190	32	36	29	6	Ø 45,25	0 4712046001 00

D Maschinengewindebohrer Speedtap-Uni/Inox,
spiral-genutet, für Whitworth-Rohrgewinde DIN ISO 228

E Machine taps Speedtap-Uni/Inox,
spiral fluted, for whitworth pipe threads DIN ISO 228

I Maschi a macchina Speedtap-Uni/Inox,
scanalature elicoidali, per filettatura whitworth per tubi, DIN ISO 228

Einsatzbereich:
HSSE-PM Gewindebohrer für Grundgewinde. Besonders geeignet für unlegierte, legierte sowie rostfreie Cr-Ni-Stähle ≤1300 N/mm².

Range of application:
Tap made of powder steel for blind hole threads. Especially suitable for non-alloyed and alloyed steels and for stainless Cr-Ni-steels ≤1300 N/mm².

Impiego:
Maschi in acciaio sinterizzato HSSE-PM per fori ciechi. Particolarmente adatti per acciai legati e non legati e per acciai inossidabili Cr-Ni ≤1300 N/mm².

Speedtap

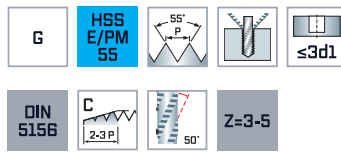

HARDOUR

d1 inch	P Gg / 1"	l1 mm	l2 mm	d2 _{h9} mm	a _{h12} mm	Z		Code 4752 Art.-Nr.
G 1/8"	28	90	12	7	5,5	3	0	0 4752016001 00
G 1/4"	19	100	15	11	9	4	0	0 4752020001 00
G 3/8"	19	100	15	12	9	4	0	0 4752024001 00
G 1/2"	14	125	18	16	12	4	0	0 4752028001 00
G 5/8"	14	125	18	18	14,5	4	0	0 4752032001 00
G 3/4"	14	140	20	20	16	5	0	0 4752034001 00
G 1"	11	160	22	25	20	5	0	0 4752038001 00



D Maschinengewindebohrer Speedtap-Inox,
gerade genutet, für Whitworth-Rohrgewinde DIN ISO 228

E Machine taps Speedtap-Inox,
straight fluted, for whitworth pipe threads DIN ISO 228

I Maschi a macchina Speedtap-Inox,
scanalature diritte, per filettatura whitworth per tubi, DIN ISO 228

Einsatzbereich:
HSSE Gewindebohrer für Durchgangsgewinde. Besonders geeignet für unlegierte, legierte sowie rostfreie Cr-Ni-Stähle ≤1200 N/mm².

Range of application:
HSS Cobalt tap for through hole threads. Especially suitable for non-alloyed and alloyed steels and for stainless Cr-Ni-steels ≤1200 N/mm².

Impiego:
Maschi in acciaio super rapido al Cobalto HSSE per fori passanti. Particolarmente adatti per acciai legati e non legati e per acciai inossidabili Cr-Ni ≤1200 N/mm².

Speedtap

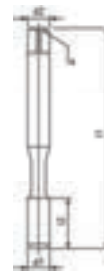
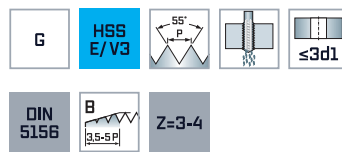

VAPD

d1 inch	P Gg / 1"	l1 mm	l2 mm	d2 _{h9} mm	a _{h12} mm	Z		Code 4722 Art.-Nr.
G 1/8"	28	90	20	7	5,5	3	Ø 8,8	0 4722016001 00
G 1/4"	19	100	22	11	9	3	Ø 11,8	0 4722020001 00
G 3/8"	19	100	22	12	9	3	Ø 15,25	0 4722024001 00
G 1/2"	14	125	25	16	12	3	Ø 19	0 4722028001 00
G 5/8"	14	125	25	18	14,5	4	Ø 21	0 4722032001 00
G 3/4"	14	140	28	20	16	4	Ø 24,5	0 4722034001 00
G 7/8"	14	150	28	22	18	4	Ø 28,25	0 4722036001 00
G 1"	11	160	30	25	20	4	Ø 30,75	0 4722038001 00

D Maschinengewindebohrer Speedtap-Inox,
spiral-genutet, für Whitworth-Rohrgewinde DIN ISO 228

E Machine taps Speedtap-Inox,
spiral fluted, for whitworth pipe threads DIN ISO 228

I Maschi a macchina Speedtap-Inox,
scanalature elicoidali, per filettatura whitworth per tubi, DIN ISO 228

Einsatzbereich:
HSSE Gewindebohrer für Grundgewinde. Besonders geeignet für unlegierte, legierte sowie rostfreie Cr-Ni-Stähle ≤1200 N/mm².

Range of application:
HSS Cobalt tap for blind hole threads. Especially suitable for non-alloyed and alloyed steels and for stainless Cr-Ni-steels ≤1200 N/mm².

Impiego:
Maschi in acciaio super rapido al Cobalto HSSE per fori ciechi. Particolarmente adatti per acciai legati e non legati e per acciai inossidabili Cr-Ni ≤1200 N/mm².

Speedtap

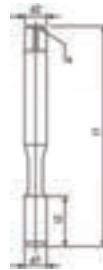
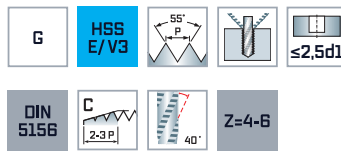

d1 inch	P Gg / 1"	l1 mm	l2 mm	d2 _{h9} mm	a _{h12} mm	Z		Code 4732 Art.-Nr.
G 1/8"	28	90	11	7	5,5	4	0 8,8	0 4732016001 00
G 1/4"	19	100	16	11	9	4	0 11,8	0 4732020001 00
G 3/8"	19	100	16	12	9	5	0 15,25	0 4732024001 00
G 1/2"	14	125	22	16	12	5	0 19	0 4732028001 00
G 5/8"	14	125	22	18	14,5	5	0 21	0 4732032001 00
G 3/4"	14	140	22	20	16	5	0 24,5	0 4732034001 00
G 7/8"	14	150	22	22	18	5	0 28,25	0 4732036001 00
G 1"	11	160	28	25	20	5	0 30,75	0 4732038001 00
G 1 1/8"	11	170	30	28	22	5	0 35,3	0 4732040001 00
G 1 1/4"	11	170	30	32	24	6	0 39,25	0 4732042001 00
G 1 3/8"	11	180	32	36	29	6	0 41,9	0 4732044001 00
G 1 1/2"	11	190	32	36	29	6	0 45,25	0 4732046001 00



D Maschinengewindeformer Speedtap-Universal, mit Ölnuten, für Whitworth-Rohrgewinde DIN ISO 228

Einsatzbereich:
HSSE Gewindeformer für Durchgangs- und Grundgewinde. Besonders geeignet für unlegierte, und legierte Stähle $\leq 1300 \text{ N/mm}^2$, Aluminium Si $\leq 10\%$.

Speedtap

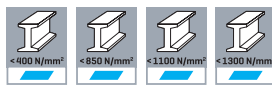

E Rolling taps Speedtap-Universal, with oil grooves, for whitworth pipe threads DIN ISO 228

Range of application:
HSS Cobalt rolling tap for through hole threads and blind hole threads. Especially suitable for non-alloyed and alloyed steels $\leq 1300 \text{ N/mm}^2$, aluminium Si $\leq 10\%$.

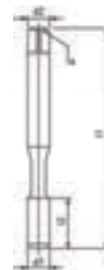
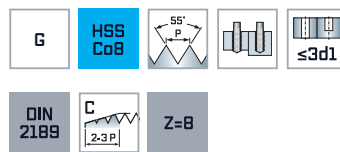

I Maschi a macchina a rulare Speedtap-Universal, con scanalature per lubrificazione, per filettatura whitworth per tubi, DIN ISO 228

Impiego:
Maschi a rullare in acciaio super rapido al Cobalto HSSE per fori passanti e fori ciechi. Particolarmente adatti per acciai legati e non legati $\leq 1300 \text{ N/mm}^2$, alluminio Si $\leq 10\%$.



d1 inch	P Gg / 1"	l1 mm	l2 mm	d2 _{h9} mm	a _{h12} mm	Z		Code 4692 Art.-Nr.
G 1/8"	28	90	9	7	5,5	8	Ø 9,3	0 4692016001 00
G 1/4"	19	100	13	11	9	8	Ø 12,5	0 4692020001 00
G 3/8"	19	100	13	12	9	8	Ø 16	0 4692024001 00
G 1/2"	14	125	18	16	12	8	Ø 20	0 4692028001 00